

# HZ106

## High Precision Motorized ZDeck



Large cutout in the rear of main support plate provides ample clearance for transmitted light condenser.

Prior Scientific's new HZ106 motorized XYZ Deck is the latest in the DECK series by Prior with fully motorized X, Y and Z axes. By combining dual 50mm travel motorized Z axis stages with Prior's flat top H101F stage, this newest XYZ Deck has even more of the features that researchers need including:

- Sub micron XY repeatability
- 114 mm x 75 mm of XY travel for samples requiring a larger XY scan area
- Stage height continuously adjustable from 87 mm to 391 mm
- 50 mm of motorized Z travel
- Transmitted light compatible via a large cutout in the main support plate
- 118 mm of manual adjustment which along with 50mm of motorized adjustment provides 168mm in total sample height adjustment
- Compatible with Queensgate Piezo Z models
- Fast up/down control via XY and Z joysticks
- 25 kg Z axis lifting capacity
- Fits standard 160 mm x 110 mm Prior sample holders
- Compatible with most imaging software via the Prior ProScan III controllers

### Key Features

- Sub micron repeatability
- 25 kg load lifting capacity
- Can be used with Queensgate Piezo Z module
- Height adjustable from 87 mm up to 391 mm
- Compatible with most imaging software
- Stable dual motorized Z axis stages

### Applications

- Multi-photon confocal microscopy
- Two photon microscopy
- Live animal research

## Technical Information

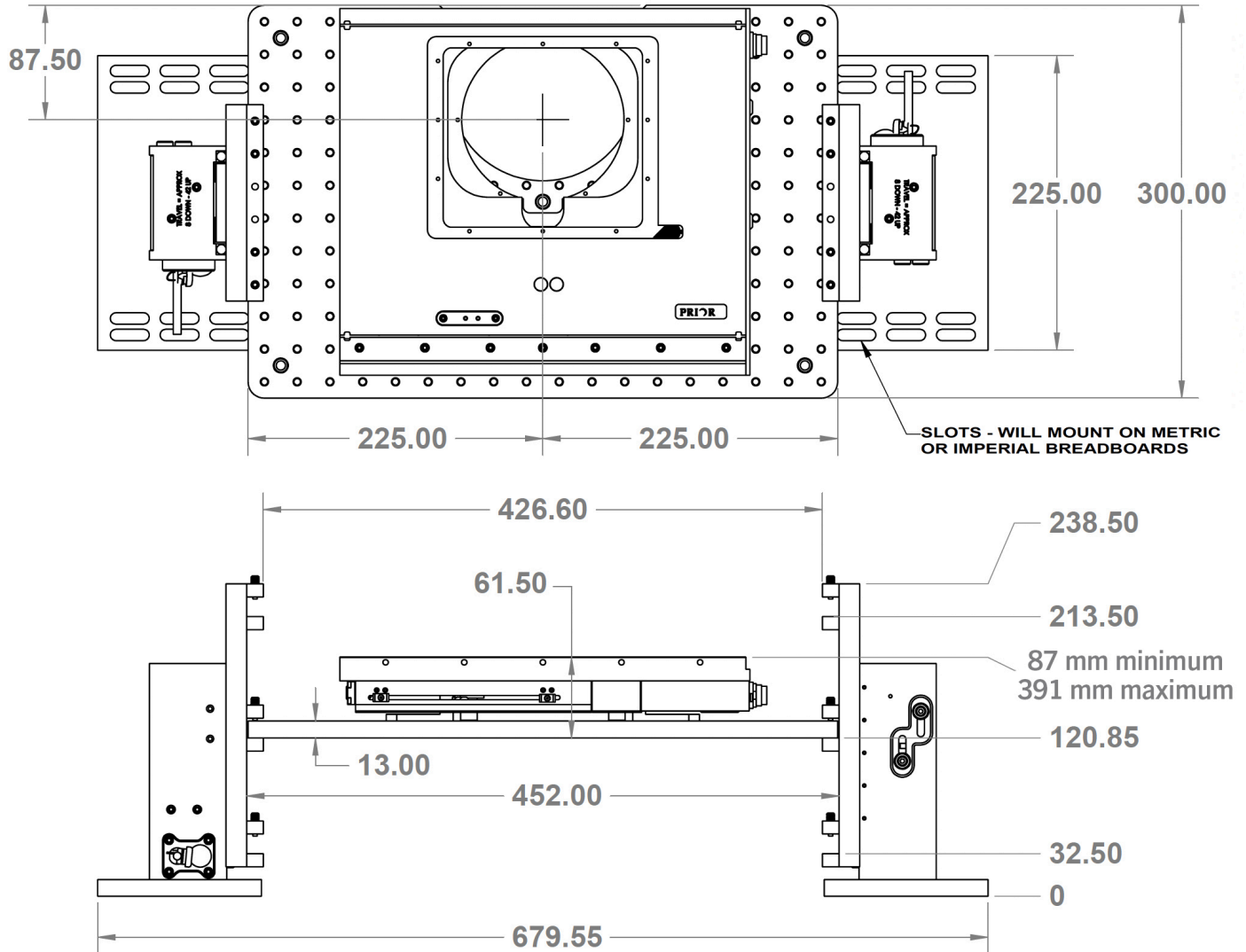

## Ordering Information

Part Number	Description
HZ106KT1	Motorized XYZ deck kit includes XY translation stage with 50mm of motorized XYZ axis travel including HMTS5050 translation stage, H31XYZE ProScan controller, dual 50mm travel focus blocks, CS100XY and CS100Z joysticks, 200mm x 600mm breadboard baseplate, 300mm x 450mm breadboard experiment plate and 150mm x 450mm breadboard with cutout to accept standard Prior sample holders. Kit includes H473UP universal sample holder.

### UNITED KINGDOM

Prior Scientific Instruments Ltd.  
 Units 3-4 Fielding Industrial Estate  
 Wilbraham Road, Fulbourn  
 Cambridge, CB21 5ET  
 United Kingdom  
 Email: inquiries@prior.com  
 Phone: +44 (0)1223 881711

### U.S.A.

Prior Scientific, Inc.  
 80 Reservoir Park Drive  
 Rockland, MA. 02370  
 U.S.A.  
 Email: info@prior.com  
 Phone: +1 781.878.8442

### GERMANY

Prior Scientific Instruments GmbH  
 Maria-Pawlowna-Str. 4  
 D-07743, Jena, Germany  
 Email: jena@prior.com  
 Phone: +49 (0) 3641 24 20 10

### JAPAN

Kayabacho 3rd Nagaoka Bldg 10F,  
 2-7-10, Nihonbashi Kayabacho, Chuo-Ku,  
 Tokyo103-0025, Japan  
 Email: info-japan@prior.com  
 Phone: 03-5652-8831

### CHINA

Prior Scientific Instruments (Suzhou) Ltd.  
 Room 1812, Honghai Building,  
 72 Xingdu Street, Suzhou Industrial Park,  
 Suzhou, 215000 China  
 Email: info-china@prior.com  
 Phone: +86 (0)512 6617 5866

